

# FLOAT LEVEL SWITCH MINIATURE TYPE

SIDE / TOP MOUNTED (ALL SS)



IPS-LS-02

## SPECIAL FEATURES

- ECONOMICAL
- STURDY AND VERSATILE
- EASY INSTALLATION
- COMPACT DESIGN
- DIN CONNECTOR (OPTIONAL)

## APPLICATIONS

- OIL RESERVOIR
- COOLANT TANK
- STERILIZING EQUIPMENT
- PROCESSING TANK

## DIMENSIONS - STANDARD VERSION



LB-1

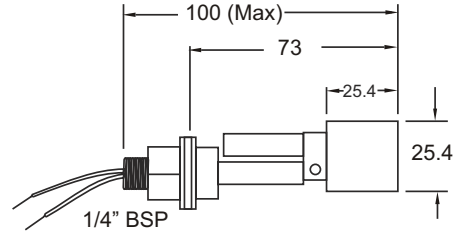

LB-2

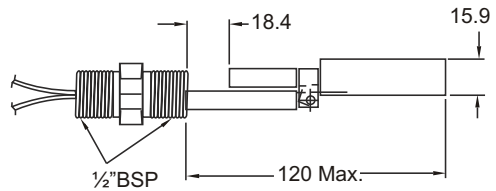

LB-3

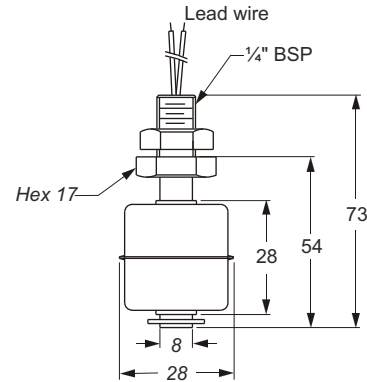

LB-4

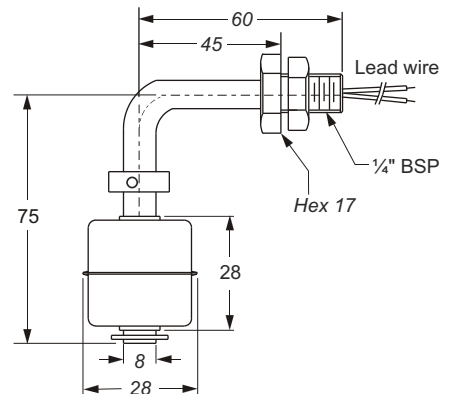

Notes : • Drawings are not to scale. • All Dimensions are in mm



**Industrix Precise Solutions Private Limited**

Room No – 303, Bhumika Residency, Plot No-21, Sector-20, Roadpali, Kalamboli, Panvel (Tal.), Raigad (Dist.), Maharashtra, India – 410218.

Mobile: +91 99309 98399 / +91 99674 97447

E-mail: [admin@ipspl.in](mailto:admin@ipspl.in) / [sales@ipspl.in](mailto:sales@ipspl.in) Website: [www.ipspl.in](http://www.ipspl.in)

CIN : U52399MH2021PTC368555

## SPECIFICATIONS STANDARD VERSION :

MODEL	LB-1	LB-2	LB-3	LB-4
Mounting	Side	Side	Top	Top (90° Angular)
Material of Float / Stem	AISI 316 SS	AISI 316 SS	AISI 316 SS	AISI 316 SS
Process Connection	1/4" BSP (M)	1/2" BSP (M)	1/4" BSP (M)	1/4" BSP (M)
DIN Connector (Optional)	No	Yes	No	No
Max. Temperature	100°C	100°C	100°C	100°C
Max. Pressure	10 bar	10 bar	10 bar	10 bar
Min Specific Gravity	0.75	0.80	0.75	0.75
Switching Differential	± 3 mm	± 3 mm	± 3 mm	± 3 mm
Reed Switch	Hermetically sealed	Hermetically sealed	Hermetically sealed	Hermetically sealed
Switch Rating	0.5 Amp	0.5 Amp	0.5 Amp	0.5 Amp
Switching Voltage	230 VAC	230 VAC	230 VAC	230 VAC
Carrying Current	1 Amp	1 Amp	1 Amp	1 Amp
Insulation Resistance	100 Ω	100 Ω	100 Ω	100 Ω

## HOW TO ORDER

### BASIC MODEL

### VERSION

LB-1      LB-2      LB-3      LB-4

### REED SWITCH

- 1      1 SPST (0.5 Amp, 230 VAC) (Standard)
- 2      1 SPDT (0.5 Amp, 230 VAC)

### PROCESS CONNECTION

LB-1	LB-2	LB-3	LB-4
<b>2BM</b> 1/4" BSP (M)(Standard)	<b>4BM</b> 1/2" BSP (M)(Standard)	<b>2BM</b> 1/4" BSP (M)(Standard)	<b>2BM</b> 1/4" BSP (M)(Standard)
<b>2NM</b> 1/4" NPT (M)	<b>4NM</b> 1/2" NPT(M)	<b>4BM</b> 1/2" BSP (M)	<b>4BM</b> 1/2" BSP (M)
<b>4BM</b> 1/2" BSP (M)	<b>5NM</b> 3/4" NPT (M)	<b>4NM</b> 1/2" NPT(M)	<b>4NM</b> 1/2" NPT(M)
<b>4NM</b> 1/2" NPT(M)	<b>6NM</b> 1" NPT (M)		

### OPTIONS

FOR NON STANDARD PRODUCTS/OPTIONAL ITEMS, PLEASE CONTACT FACTORY FOR DELIVERY AND MINIMUM QUANTITY OF ORDER.

**SX** SS TAG PLATE      **GH** MATERIAL TEST CERTIFICATES\*\*      **DC** DIN CONNECTOR (For Model Lb2 only)

\*\* MATERIAL TEST CERTIFICATES WILL BE PROVIDED FOR WETTED PARTS ONLY WITH CHEMICAL COMPOSITION TESTING. FOR OTHERS, PLEASE CONSULT FACTORY

Note : Specifications and dimensions given in this product catalogue represents the state of engineering at the time of printing.  
Modifications may take place and materials specified may be replaced by others without prior notice.

IPS-LS-02

XXX

X

XXX

XX

